

## U10 – RASTER 40

### PROFIL ALU 40x40 L – U10

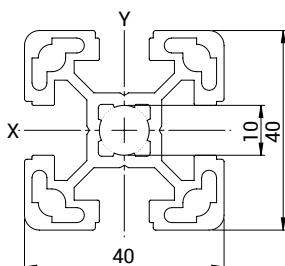
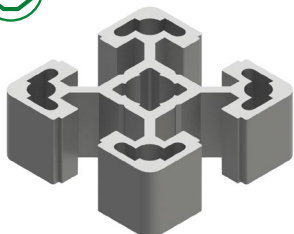

KAPA / CAP: 82015

KODA NAROČANJA: **P4040LU10** / /

Konstruktivski podatki  
 Construction specifications:

Material = Al Mg Si 0,5 F25  
 $m = 1,51 \text{ kg/m}$   
 $A = 5,61 \text{ cm}^2$   
 $I_x = 9,06 \text{ cm}^4$   
 $W_x = 4,53 \text{ cm}^3$   
 $I_y = 9,06 \text{ cm}^4$   
 $W_y = 4,53 \text{ cm}^3$

Primeri obdelav na strani 8.  
 Machining examples on page 8.

	7000	-	12000

### PROFIL ALU 40x80 L – U10

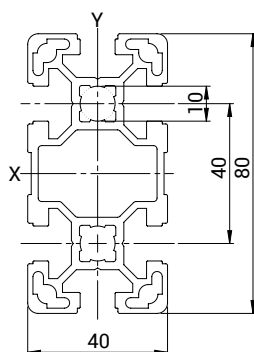
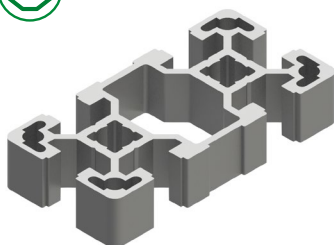

KAPA / CAP: 82016

KODA NAROČANJA: **P4080LU10** / /

Konstruktivski podatki  
 Construction specifications:

Material = Al Mg Si 0,5 F25  
 $m = 2,66 \text{ kg/m}$   
 $A = 9,86 \text{ cm}^2$   
 $I_x = 63,24 \text{ cm}^4$   
 $W_x = 15,81 \text{ cm}^3$   
 $I_y = 17,23 \text{ cm}^4$   
 $W_y = 8,61 \text{ cm}^3$

Primeri obdelav na strani 8.  
 Machining examples on page 8.

	7000	-	12000

## U10 – RASTER 45

### PROFIL ALU 45x45 L – U10

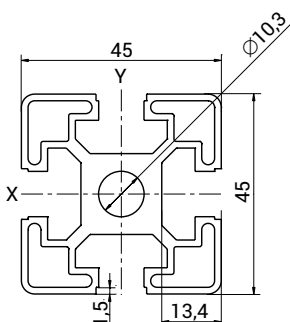
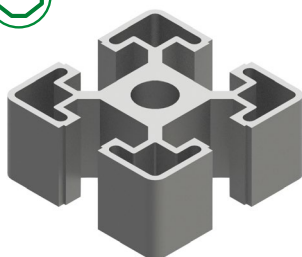

KAPA / CAP: 5602

KODA NAROČANJA: **P4545LU10** / /

Konstruktivski podatki  
 Construction specifications:

Material = Al Mg Si 0,5 F25  
 $m = 1,55 \text{ kg/m}$   
 $A = 5,73 \text{ cm}^2$   
 $I_x = 10,54 \text{ cm}^4$   
 $W_x = 4,68 \text{ cm}^3$   
 $I_y = 10,54 \text{ cm}^4$   
 $W_y = 4,68 \text{ cm}^3$

Primeri obdelav na strani 8.  
 Machining examples on page 8.

	7000	10000	12000

### PROFIL ALU 45x45 L – U10

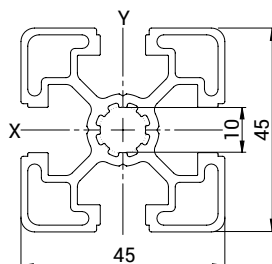
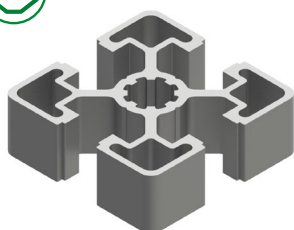

KAPA / CAP: 5602

KODA NAROČANJA: **P4545LU10MB** / /

Konstruktivski podatki  
 Construction specifications:

Material = Al Mg Si 0,5 F25  
 $m = 1,55 \text{ kg/m}$   
 $A = 5,73 \text{ cm}^2$   
 $I_x = 11,00 \text{ cm}^4$   
 $W_x = 4,89 \text{ cm}^3$   
 $I_y = 11,00 \text{ cm}^4$   
 $W_y = 4,89 \text{ cm}^3$

Primeri obdelav na strani 8.  
 Machining examples on page 8.

	7000	10000	12000

**PROFIL ALU 45x45 L 1N – U10**

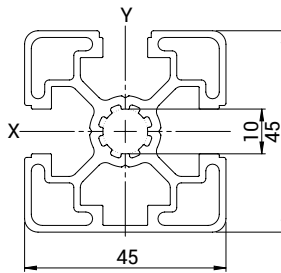
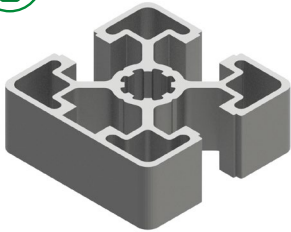

KAPA / CAP: 5602

**KODA NAROČANJA:** P4545L1NU10 / /  
**ORDER CODE:**

**Konstruktivski podatki**  
Construction specifications:

Material = Al Mg Si 0,5 F25  
m = 1,57 kg/m  
A = 5,83 cm<sup>2</sup>  
I<sub>x</sub> = 11,65 cm<sup>4</sup>  
W<sub>x</sub> = 5,03 cm<sup>3</sup>  
I<sub>y</sub> = 10,87 cm<sup>4</sup>  
W<sub>y</sub> = 4,83 cm<sup>3</sup>

Primeri obdelav na strani 8.  
Machining examples on page 8.

	7000	10000	12000

**PROFIL ALU 45x45 L 2N90° – U10**

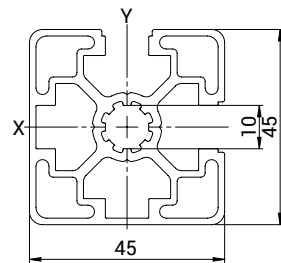
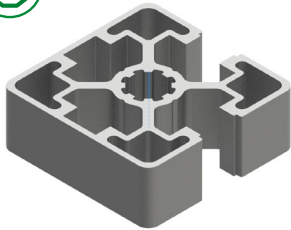

KAPA / CAP: 5602

**KODA NAROČANJA:** P4545L2N90U10 / /  
**ORDER CODE:**

**Konstruktivski podatki**  
Construction specifications:

Material = Al Mg Si 0,5 F25  
m = 1,64 kg/m  
A = 6,08 cm<sup>2</sup>  
I<sub>x</sub> = 11,82 cm<sup>4</sup>  
W<sub>x</sub> = 5,11 cm<sup>3</sup>  
I<sub>y</sub> = 11,82 cm<sup>4</sup>  
W<sub>y</sub> = 5,11 cm<sup>3</sup>

Primeri obdelav na strani 8.  
Machining examples on page 8.

	7000	10000	12000

**PROFIL ALU 45x45 L 2N180° – U10**

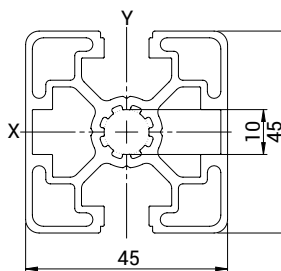
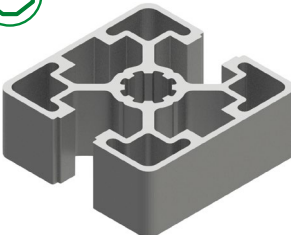

KAPA / CAP: 5602

**KODA NAROČANJA:** P4545L2N180U10 / /  
**ORDER CODE:**

**Konstruktivski podatki**  
Construction specifications:

Material = Al Mg Si 0,5 F25  
m = 1,62 kg/m  
A = 5,98 cm<sup>2</sup>  
I<sub>x</sub> = 10,83 cm<sup>4</sup>  
W<sub>x</sub> = 4,81 cm<sup>3</sup>  
I<sub>y</sub> = 12,50 cm<sup>4</sup>  
W<sub>y</sub> = 5,56 cm<sup>3</sup>

Primeri obdelav na strani 8.  
Machining examples on page 8.

	7000	10000	12000

**PROFIL ALU 45x45 L 3N – U10**

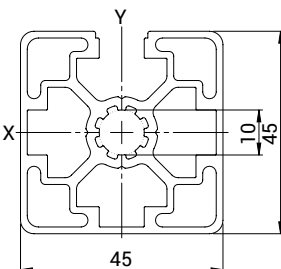
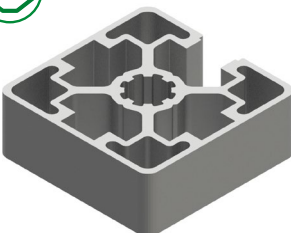

KAPA / CAP: 5602

**KODA NAROČANJA:** P4545L3NU10 / /  
**ORDER CODE:**

**Konstruktivski podatki**  
Construction specifications:

Material = Al Mg Si 0,5 F25  
m = 1,69 kg/m  
A = 6,25 cm<sup>2</sup>  
I<sub>x</sub> = 12,68 cm<sup>4</sup>  
W<sub>x</sub> = 5,64 cm<sup>3</sup>  
I<sub>y</sub> = 11,85 cm<sup>4</sup>  
W<sub>y</sub> = 5,13 cm<sup>3</sup>

Primeri obdelav na strani 8.  
Machining examples on page 8.

	7000	10000	12000

**PROFIL ALU 45x45 LR90 – U10**

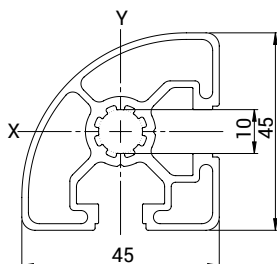
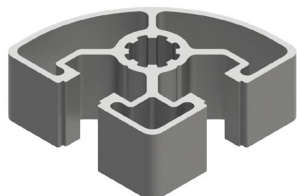

**KODA NAROČANJA:** P45R90U10 /  
**ORDER CODE:**

**Konstruktivski podatki**  
 Construction specifications:

Material = Al Mg Si 0,5 F25  
 m = 1,28 kg/m  
 A = 4,75 cm<sup>2</sup>  
 I<sub>x</sub> = 6,84 cm<sup>4</sup>  
 W<sub>x</sub> = 3,06 cm<sup>3</sup>  
 I<sub>y</sub> = 6,84 cm<sup>4</sup>  
 W<sub>y</sub> = 3,06 cm<sup>3</sup>

Primeri obdelav na strani 8.  
 Machining examples on page 8.

	7000	10000	12000

KAPA / CAP: 50568

**PROFIL ALU POLKROŽNI 45 R 30 – U10**

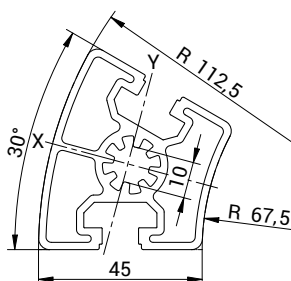
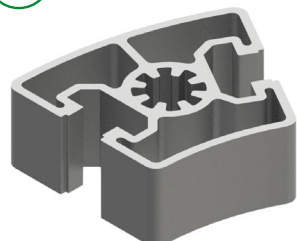

**KODA NAROČANJA:** P45R30U10 /  
**ORDER CODE:**

**Konstruktivski podatki**  
 Construction specifications:

Material = Al Mg Si 0,5 F25  
 m = 1,86 kg/m  
 A = 6,89 cm<sup>2</sup>  
 I<sub>x</sub> = 15,18 cm<sup>4</sup>  
 W<sub>x</sub> = 5,34 cm<sup>3</sup>  
 I<sub>y</sub> = 12,72 cm<sup>4</sup>  
 W<sub>y</sub> = 5,04 cm<sup>3</sup>

Primeri obdelav na strani 8.  
 Machining examples on page 8.

	7000	10000	12000

**PROFIL ALU POLKROŽNI 45 R 45 – U10**

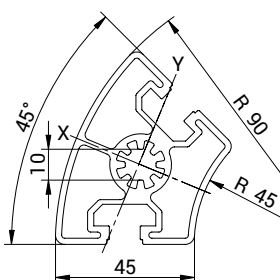
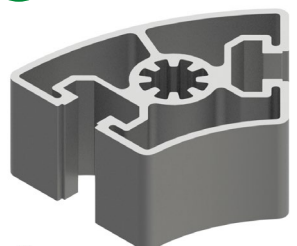

**KODA NAROČANJA:** P45R45U10 /  
**ORDER CODE:**

**Konstruktivski podatki**  
 Construction specifications:

Material = Al Mg Si 0,5 F25  
 m = 2,0 kg/m  
 A = 7,41 cm<sup>2</sup>  
 I<sub>x</sub> = 21,09 cm<sup>4</sup>  
 W<sub>x</sub> = 6,30 cm<sup>3</sup>  
 I<sub>y</sub> = 13,32 cm<sup>4</sup>  
 W<sub>y</sub> = 5,19 cm<sup>3</sup>

Primeri obdelav na strani 8.  
 Machining examples on page 8.

	7000	10000	12000

KAPA / CAP: 65234

**PROFIL ALU 45x45 N – U10**

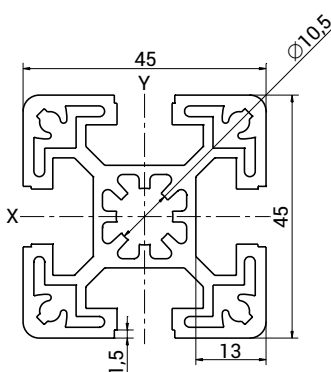
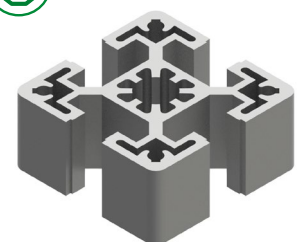

**KODA NAROČANJA:** P4545NU10 /  
**ORDER CODE:**

**Konstruktivski podatki**  
 Construction specifications:

Material = Al Mg Si 0,5 F25  
 m = 2,03 kg/m  
 A = 7,50 cm<sup>2</sup>  
 I<sub>x</sub> = 15,03 cm<sup>4</sup>  
 W<sub>x</sub> = 6,68 cm<sup>3</sup>  
 I<sub>y</sub> = 15,03 cm<sup>4</sup>  
 W<sub>y</sub> = 6,68 cm<sup>3</sup>

Primeri obdelav na strani 8.  
 Machining examples on page 8.

	12000	15000	17000

KAPA / CAP: 5602

**PROFIL ALU 45x45 S – U10**

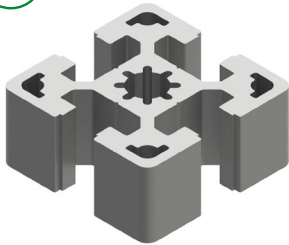

KAPA / CAP: 5602

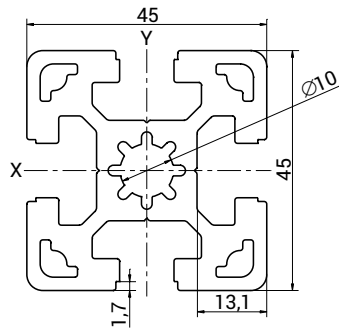

**KODA NAROČANJA:** **P4545SU10** / /

**Konstruktivski podatki**  
Construction specifications:

Material = Al Mg Si 0,5 F25  
m = 2,62 kg/m  
A = 9,70 cm<sup>2</sup>  
I<sub>x</sub> = 18,95 cm<sup>4</sup>  
W<sub>x</sub> = 8,42 cm<sup>3</sup>  
I<sub>y</sub> = 18,95 cm<sup>4</sup>  
W<sub>y</sub> = 8,42 cm<sup>3</sup>

Primeri obdelav na strani 8.  
Machining examples on page 8.

	14000	16000	19000

**PROFIL TELESKOPSKI ZA PROFIL 45x45 – U10**

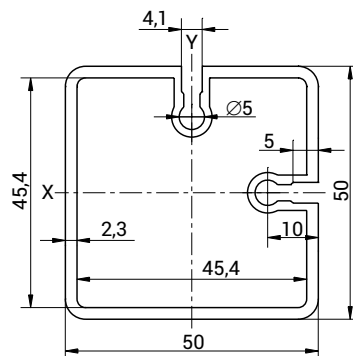
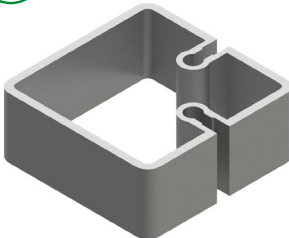

**KODA NAROČANJA:** **PT45** / /

**Konstruktivski podatki**  
Construction specifications:

Material = Al Mg Si 0,5 F25  
m = 1,40 kg/m  
A = 5,23 cm<sup>2</sup>  
I<sub>x</sub> = 17,07 cm<sup>4</sup>  
W<sub>x</sub> = 7,59 cm<sup>3</sup>  
I<sub>y</sub> = 17,07 cm<sup>4</sup>  
W<sub>y</sub> = 7,59 cm<sup>3</sup>

	14000	16000	19000

**PROFIL ALU 45x60 N – U10**



KAPA / CAP: 5603

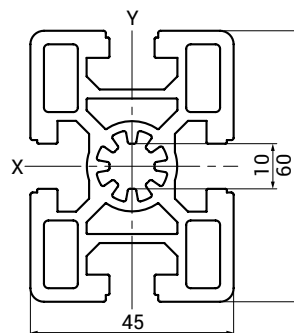

**KODA NAROČANJA:** **P4560NU10** / /

**Konstruktivski podatki**  
Construction specifications:

Material = Al Mg Si 0,5 F25  
m = 3,01 kg/m  
A = 11,14 cm<sup>2</sup>  
I<sub>x</sub> = 37,55 cm<sup>4</sup>  
W<sub>x</sub> = 12,52 cm<sup>3</sup>  
I<sub>y</sub> = 22,66 cm<sup>4</sup>  
W<sub>y</sub> = 10,07 cm<sup>3</sup>

Primeri obdelav na strani 8.  
Machining examples on page 8.

	14000	16000	19000

**PROFIL ALU 45x60 S – U10**



KAPA / CAP: 5603

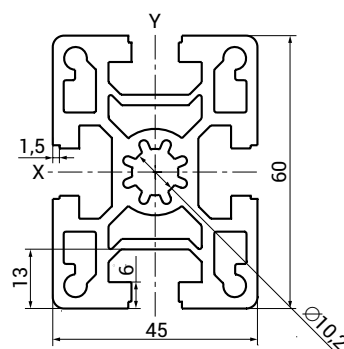

**KODA NAROČANJA:** **P4560SU10** / /

**Konstruktivski podatki**  
Construction specifications:

Material = Al Mg Si 0,5 F25  
m = 3,30 kg/m  
A = 12,23 cm<sup>2</sup>  
I<sub>x</sub> = 41,06 cm<sup>4</sup>  
W<sub>x</sub> = 13,69 cm<sup>3</sup>  
I<sub>y</sub> = 23,68 cm<sup>4</sup>  
W<sub>y</sub> = 10,52 cm<sup>3</sup>

Primeri obdelav na strani 8.  
Machining examples on page 8.

	18000	18000	24000

**PROFIL ALU 45x90 L – U10**

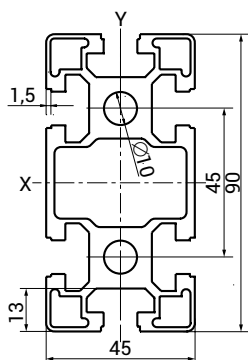
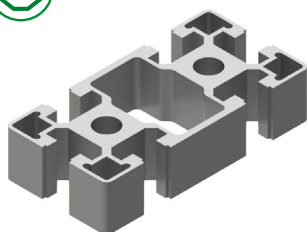

KAPA / CAP: 5604

**KODA NAROČANJA:** **P4590LU10** /

Konstruktivski podatki  
 Construction specifications:

Material = Al Mg Si 0,5 F25  
 $m = 3,05 \text{ kg/m}$   
 $A = 11,27 \text{ cm}^2$   
 $I_x = 90,13 \text{ cm}^4$   
 $W_x = 20,03 \text{ cm}^3$   
 $I_y = 23,4 \text{ cm}^4$   
 $W_y = 10,42 \text{ cm}^3$

Primeri obdelav na strani 8.  
 Machining examples on page 8.

	7000	10000	12000

**PROFIL ALU 45x90 L 2N – U10**

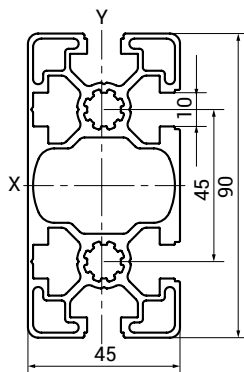
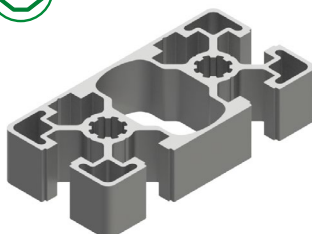

KAPA / CAP: 5604

**KODA NAROČANJA:** **P4590L2NU10** /

Konstruktivski podatki  
 Construction specifications:

Material = Al Mg Si 0,5 F25  
 $m = 2,97 \text{ kg/m}$   
 $A = 11,01 \text{ cm}^2$   
 $I_x = 82,60 \text{ cm}^4$   
 $W_x = 18,36 \text{ cm}^3$   
 $I_y = 24,84 \text{ cm}^4$   
 $W_y = 10,72 \text{ cm}^3$

Primeri obdelav na strani 8.  
 Machining examples on page 8.

	7000	10000	12000

**PROFIL ALU 45x90 L 3N90 – U10**

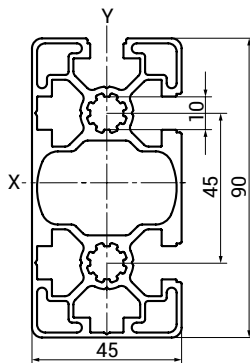
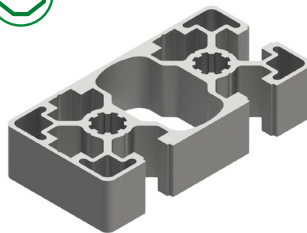

KAPA / CAP: 5604

**KODA NAROČANJA:** **P4590L3N90U10** /

Konstruktivski podatki  
 Construction specifications:

Material = Al Mg Si 0,5 F25  
 $m = 3,15 \text{ kg/m}$   
 $A = 11,66 \text{ cm}^2$   
 $I_x = 86,78 \text{ cm}^4$   
 $W_x = 19,01 \text{ cm}^3$   
 $I_y = 24,93 \text{ cm}^4$   
 $W_y = 10,77 \text{ cm}^3$

Primeri obdelav na strani 8.  
 Machining examples on page 8.

	7000	10000	12000

**PROFIL ALU 45x90 L 4N180 – U10**

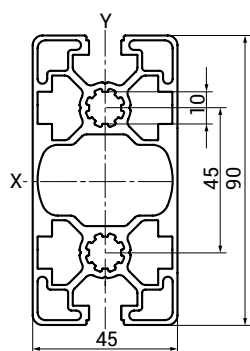
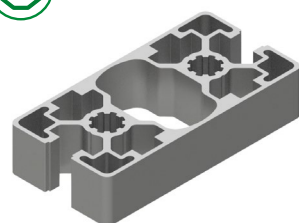

KAPA / CAP: 5604

**KODA NAROČANJA:** **P4590L4N180U10** /

Konstruktivski podatki  
 Construction specifications:

Material = Al Mg Si 0,5 F25  
 $m = 3,31 \text{ kg/m}$   
 $A = 11,99 \text{ cm}^2$   
 $I_x = 85,44 \text{ cm}^4$   
 $W_x = 18,98 \text{ cm}^3$   
 $I_y = 26,85 \text{ cm}^4$   
 $W_y = 11,93 \text{ cm}^3$

Primeri obdelav na strani 9.  
 Machining examples on page 9.

	7000	10000	12000

**PROFIL ALU 45x90 S – U10**

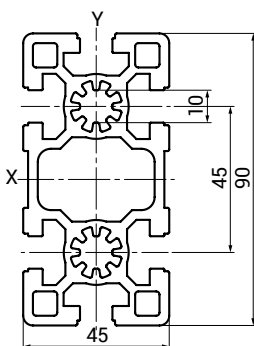
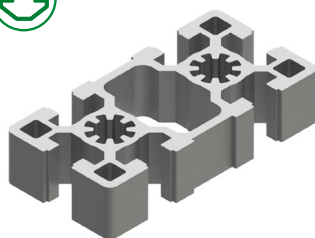

**KODA NAROČANJA:** P4590SU10 /  
**ORDER CODE:**

**Konstruktivski podatki**  
Construction specifications:  
Material = Al Mg Si 0,5 F25  
m = 4,26 kg/m  
A = 15,77 cm<sup>2</sup>  
I<sub>x</sub> = 124,05 cm<sup>4</sup>  
W<sub>x</sub> = 27,57 cm<sup>3</sup>  
I<sub>y</sub> = 32,55 cm<sup>4</sup>  
W<sub>y</sub> = 14,33 cm<sup>3</sup>

Primeri obdelav na strani 9.  
Machining examples on page 9.

	14000	16000	19000

KAPA / CAP: 5604

**PROFIL ALU 45x180 – U10**

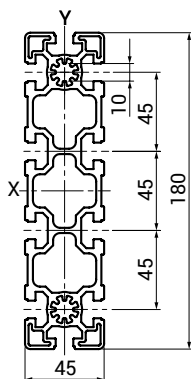
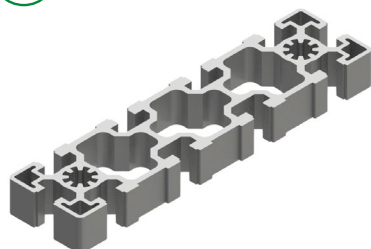

**KODA NAROČANJA:** P45180U10 /  
**ORDER CODE:**

**Konstruktivski podatki**  
Construction specifications:  
Material = Al Mg Si 0,5 F25  
m = 6,96 kg/m  
A = 25,78 cm<sup>2</sup>  
I<sub>x</sub> = 771,07 cm<sup>4</sup>  
W<sub>x</sub> = 85,67 cm<sup>3</sup>  
I<sub>y</sub> = 57,77 cm<sup>4</sup>  
W<sub>y</sub> = 25,68 cm<sup>3</sup>

Primeri obdelav na strani 9.  
Machining examples on page 9.

	14000	16000	19000

**PROFIL ALU 60x60 L – U10**

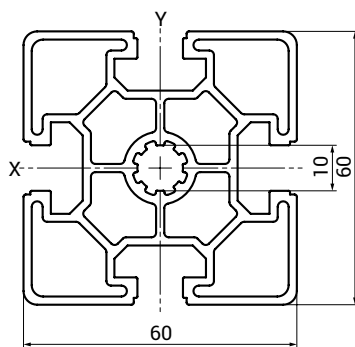
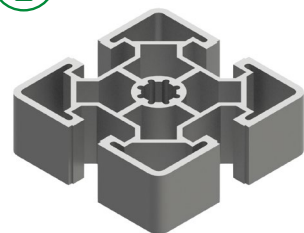

**KODA NAROČANJA:** P6060LU10 /  
**ORDER CODE:**

**Konstruktivski podatki**  
Construction specifications:  
Material = Al Mg Si 0,5 F25  
m = 2,57 kg/m  
A = 9,52 cm<sup>2</sup>  
I<sub>x</sub> = 31,71 cm<sup>4</sup>  
W<sub>x</sub> = 10,57 cm<sup>3</sup>  
I<sub>y</sub> = 31,71 cm<sup>4</sup>  
W<sub>y</sub> = 10,57 cm<sup>3</sup>

Primeri obdelav na strani 8.  
Machining examples on page 8.

	7000	10000	12000

KAPA / CAP: 5605

**PROFIL ALU 60x60 S – U10**

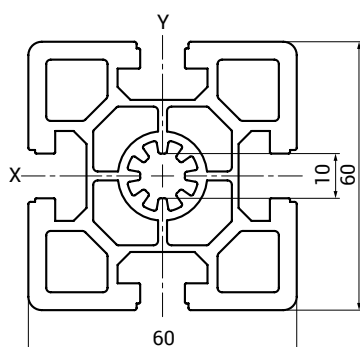
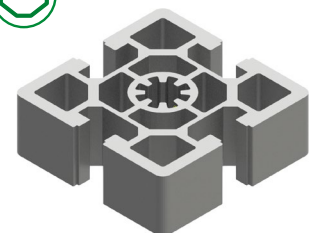

**KODA NAROČANJA:** P6060SU10 /  
**ORDER CODE:**

**Konstruktivski podatki**  
Construction specifications:  
Material = Al Mg Si 0,5 F25  
m = 3,86 kg/m  
A = 14,31 cm<sup>2</sup>  
I<sub>x</sub> = 52,69 cm<sup>4</sup>  
W<sub>x</sub> = 17,56 cm<sup>3</sup>  
I<sub>y</sub> = 52,69 cm<sup>4</sup>  
W<sub>y</sub> = 17,56 cm<sup>3</sup>

Primeri obdelav na strani 8.  
Machining examples on page 8.

	14000	16000	19000

KAPA / CAP: 5605

**PROFIL ALU 60x90 S – U10**



KAPA / CAP: 5760

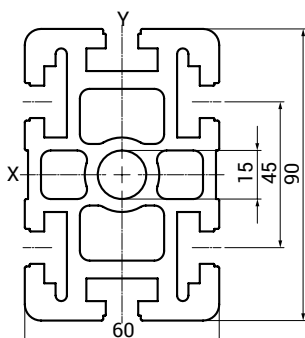

**KODA NAROČANJA:** **P6090SU10** / \_ / \_  
**ORDER CODE:**

**Konstruktivski podatki**  
 Construction specifications:

Material = Al Mg Si 0,5 F25  
 m = 6,92 kg/m  
 A = 25,64 cm<sup>2</sup>  
 I<sub>x</sub> = 212,45 cm<sup>4</sup>  
 W<sub>x</sub> = 47,21 cm<sup>3</sup>  
 I<sub>y</sub> = 90,43 cm<sup>4</sup>  
 W<sub>y</sub> = 30,14 cm<sup>3</sup>

Primeri obdelav na strani 8.  
 Machining examples on page 8.

	18000	18000	24000

**PROFIL ALU 90x90 L – U10**

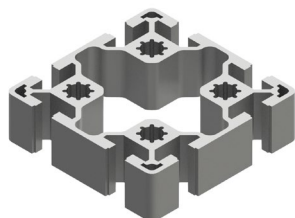

KAPA / CAP: 5606

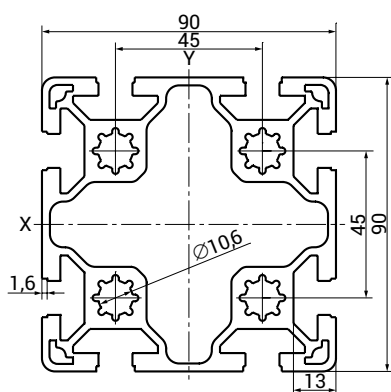

**KODA NAROČANJA:** **P9090LU10** / \_ / \_  
**ORDER CODE:**

**Konstruktivski podatki**  
 Construction specifications:

Material = Al Mg Si 0,5 F25  
 m = 5,38 kg/m  
 A = 19,86 cm<sup>2</sup>  
 I<sub>x</sub> = 180,76 cm<sup>4</sup>  
 W<sub>x</sub> = 40,17 cm<sup>3</sup>  
 I<sub>y</sub> = 180,76 cm<sup>4</sup>  
 W<sub>y</sub> = 40,17 cm<sup>3</sup>

Primeri obdelav na strani 9.  
 Machining examples on page 9.

	7000	10000	12000

**PROFIL ALU 90x90 S – U10**

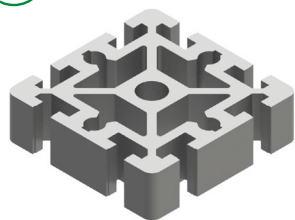

KAPA / CAP: 5761

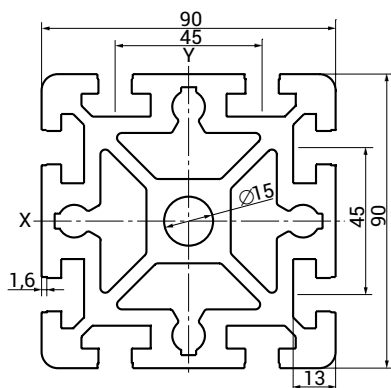

**KODA NAROČANJA:** **P9090SU10** / \_ / \_  
**ORDER CODE:**

**Konstruktivski podatki**  
 Construction specifications:

Material = Al Mg Si 0,5 F25  
 m = 10,48 kg/m  
 A = 38,69 cm<sup>2</sup>  
 I<sub>x</sub> = 302,56 cm<sup>4</sup>  
 W<sub>x</sub> = 67,23 cm<sup>3</sup>  
 I<sub>y</sub> = 302,56 cm<sup>4</sup>  
 W<sub>y</sub> = 67,23 cm<sup>3</sup>

Primeri obdelav na strani 9.  
 Machining examples on page 9.

	18000	18000	24000

**PROFIL ALU 90x180 L – U10**



KAPA / CAP: 2 x 5606

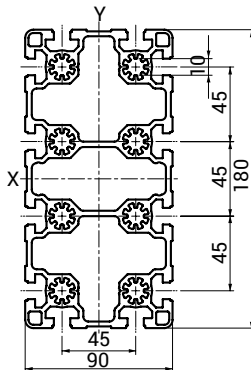

**KODA NAROČANJA:** **P90180LU10** / /

**Konstruktivski podatki**  
Construction specifications:

Material = Al Mg Si 0,5 F25  
m = 11,41 kg/m  
A = 42,26 cm<sup>2</sup>  
I<sub>x</sub> = 1379,86 cm<sup>4</sup>  
W<sub>x</sub> = 153,10 cm<sup>3</sup>  
I<sub>y</sub> = 398,86 cm<sup>4</sup>  
W<sub>y</sub> = 88,63 cm<sup>3</sup>

Primeri obdelav na strani 9.  
Machining examples on page 9.

	7000	10000	12000

**PROFIL ALU 90x180 S – U10**



KAPA / CAP: 2 x 5761

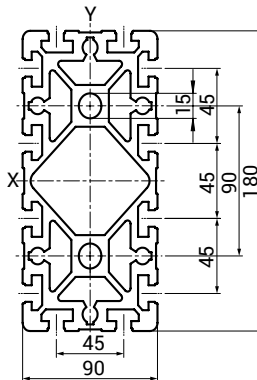

**KODA NAROČANJA:** **P90180SMB-U10** / /

**Konstruktivski podatki**  
Construction specifications:

Material = Al Mg Si 0,5 F25  
m = 17,17 kg/m  
A = 63,57 cm<sup>2</sup>  
I<sub>x</sub> = 2142,58 cm<sup>4</sup>  
W<sub>x</sub> = 238,10 cm<sup>3</sup>  
I<sub>y</sub> = 547,41 cm<sup>4</sup>  
W<sub>y</sub> = 121,64 cm<sup>3</sup>

Primeri obdelav na strani 9.  
Machining examples on page 9.

	18000	18000	24000

**PROFIL ALU 45x45 ST – U10 DRSNNA VRATA**

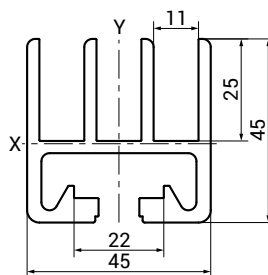
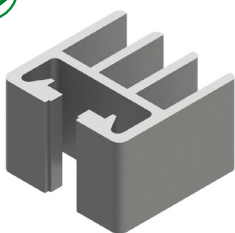

**KODA NAROČANJA:** **P4545U10ST** / /

**Konstruktivski podatki**  
Construction specifications:

Material = Al Mg Si 0,5 F25  
m = 1,90 kg/m  
A = 7,03 cm<sup>2</sup>  
I<sub>x</sub> = 12,28 cm<sup>4</sup>  
W<sub>x</sub> = 4,78 cm<sup>3</sup>  
I<sub>y</sub> = 16,83 cm<sup>4</sup>  
W<sub>y</sub> = 7,48 cm<sup>3</sup>

	18000	18000	24000